

P A T E N T E D

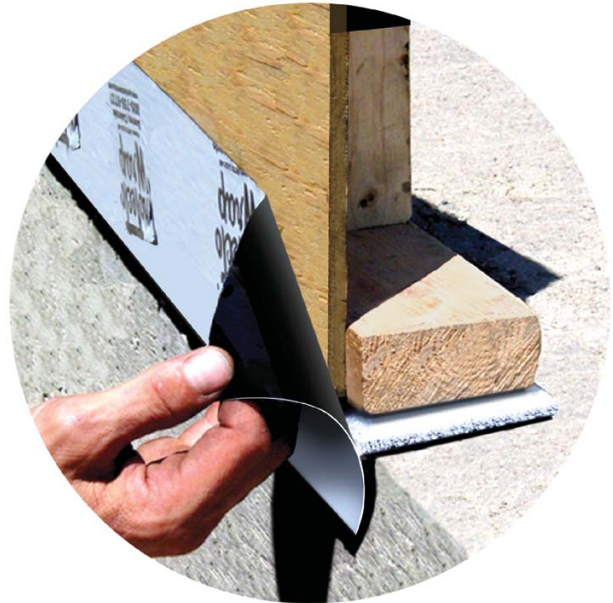

Serious Waterproofing Solutions

Protecto Triple Guard Energy Sill Sealer™



The only Self-Adhesive Air and Moisture Sill Barrier.

Known as a major cause of energy loss and water infiltration in residential and commercial construction, the voids and irregularities between the top of the concrete foundation and sill plates leak. These leaks are a major cause of costly callbacks for builders across the nation. Triple Guard's triple protection adheres to the face of the foundation, adheres to the top of the foundation wall and adheres to the face of the sill plate/skirt board, totally sealing off the cold joint between the foundation and frame construction.

Concrete shrinks as it cures creating a rough and uneven surface on the top of the foundation wall. Building codes require a sill sealer to be placed between the top of the foundation and the sill plate. Conventional sill sealers do not have the thickness or the self-adhesive characteristics of Triple Guard to give them the ability to conform or seal up these irregularities leaving a tremendous amount of voids. These voids have long been recognized as one of the leading causes of basement water leaks, insect/rodent infiltration and a major area for heat and air conditioning loss.

This unique and patented design combines the peel and stick waterproofing characteristics of Protecto Wrap Company's waterproofing membranes with a $\frac{3}{8}$ " thick closed cell foam sill sealer forming a gasket seal to virtually eliminate any air, moisture and insect/rodent infiltration beneath the sill plate.

ADVANTAGES:

- Triple Guard offers three adhesive membrane areas for sealing off the cold joint between the foundation and construction framing.
- Helps lower energy costs by stopping heating and air conditioning loss at the foundation to sill plate interface.
- Helps eliminate costly call backs for builders due to leaks.
- By sealing off the cold joint between the top of the foundation and the sill plate, **Protecto Triple Guard Energy Sill Sealer™** helps keep floors warm in the winter and cool in the summer.
- A full $\frac{3}{8}$ " closed cell foam provides $1\frac{1}{2}$ times more protection from energy loss over standard $\frac{1}{4}$ " sill sealers used by builders today.
- Exceeds all local, state and national building codes.
- Self adhering for easy and precise placement.
- Mildew and water resistant – will help prevent sill plate rot.



Protecto Triple Guard Energy Sill Sealer™

Serious Waterproofing Solutions

ADVANTAGES:

- Adheres and conforms to irregularities found in the top of foundation walls.
- Extremely resilient, will not rot or deteriorate with age.
- Works on residential and commercial construction, slab on grade, crawl spaces or with basements.
- Convenient 3¹/₂" and 5¹/₂" widths (custom sizes available in quantities).
- Adheres to concrete, block, wood, metal, vinyl, brick and foam surfaces.
- Stops dangerous carbon monoxide from entering the home from garage sill areas.
- No extra tools needed, application can be done with just a utility knife.
- Virtually eliminates air, moisture and insect/rodent infiltration beneath the sill plate.
- **Protecto Triple Guard Energy Sill Sealer™** will save the homeowner thousands of dollars in energy costs over the life of the home.
- **Protecto Triple Guard Energy Sill Sealer™** comes with Protecto Wrap Company's Lifetime Guarantee.

APPLICATION:

Areas to be sealed must be clean and dry. Knock off and remove any rough or jagged edges. As you roll out Triple Guard, peel off the release liner from the bottom of the Triple Guard and place the exposed adhesive side down on top of the foundation. Bring the 1¹/₂" flap over the face of the foundation pressing or rolling the adhesive in place. The foam part of the Triple Guard should be placed flush with the outside perimeter of the foundation.

Rolling or pressing the adhesive bottom of Triple Guard is essential to properly adhere the product to the foundation. Lay top flap back out of the way of the sill plate and proceed to start your construction framing. Once the skirt board is in place, peel the release paper off of the top flap of Triple Guard and press or roll adhesive onto the skirt board. For slab on grade construction, adhere the top flap to the exterior sheathing.

Should you have re-bar or anchor bolts coming out of the foundation, simply make an "X" cut in the back of Triple Guard and slide over the protrusion pressing firmly in place. For hurricane straps, simply slit the area between the 3/8" foam and the top flap of the Triple Guard and slide over the strap.

Should the top flap of Triple Guard be damaged during construction or if the release paper is removed prior to sealing to the construction framing, prime the sheathing and the exposed adhesive with a light layer of #100 primer and allow to tack up before installing as mentioned above. Do not cover wet primer. A second layer of Triple Guard repair Tape can be placed over the sill joint covering the damaged area. All butt joints should be taped with a 4" wide piece of Protecto Triple Guard Sill Sealer Repair Tape.

INSTALLATION BELOW 40°:

- Keep **Protecto Triple Guard Energy Sill Sealer™** in a warm heated space above 60°F before use.
- Prime the top of the foundation with #100 Primer* and allow primer to tack up. Do not cover wet primer.
- Peel and stick the **Protecto Triple Guard Energy Sill Sealer™** in place.

* Note: Protecto Wrap Protecto-Tak 16.25 oz. spray adhesive may be used in place of #100 Primer.

PACKAGING:

3¹/₂" x 25' rolls, 7 rolls per case, 12 cases per pallet

5¹/₂" x 25' rolls, 4 rolls per case, 12 cases per pallet

PROTECTO WRAP COMPANY

1955 South Cherokee Denver, Colorado 80223 (303) 777-3001 Fax (303) 777-9273 1-800-759-9727

www.protectowrap.com